

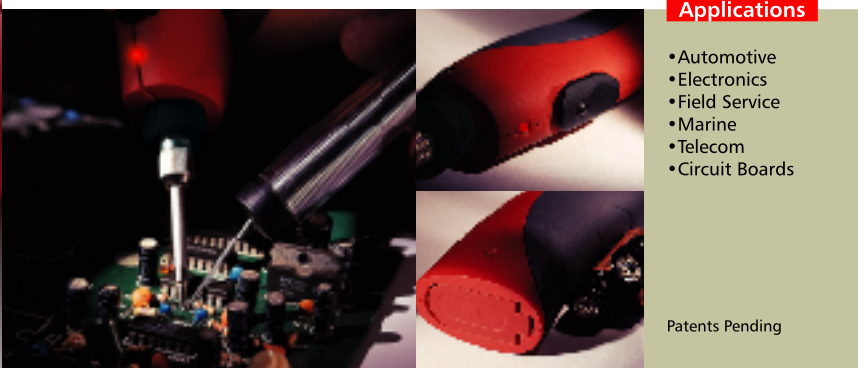

## PRO-35K SOLDERPRO™ 35K SOLDERING IRON AND FLASHLIGHT

Pro-35 is a high efficiency Battery Powered dual function portable Soldering Iron and Flashlight ideal for quick repairs of circuit boards and electronics, at home, in the car or in the field. Using readily available alkaline batteries, there is always power at hand for locating and performing emergency repairs. Rapid 12 second heat-up, extended precision tip and simple push-button activation allow quick on-the spot repairs. A great addition to all emergency and auto tool kits.



### Applications

- Automotive
- Electronics
- Field Service
- Marine
- Telecom
- Circuit Boards

Patents Pending

### BATTERY POWERED DUAL FUNCTION PORTABLE SOLDERING IRON/ FLASHLIGHT

#### Features

- Equivalent to a 9 Watt iron at 480°C max.
- Lightweight and completely portable
- Solder up to 160 joints with fully charged batteries
- Approximately 50 minutes of continuous use
- Fast start-up, reaches 365°F/185°C in 12 seconds
- Dual function of soldering iron and flashlight
- Use to solder & de-solder micro to medium sized parts, Perfect for field service and repair work

**iroda**

Battery Powered  
**Dual-Function Portable  
Soldering Iron / Flashlight**  
SolderPro 35 9 W

#### Specifications:

Outer Dimensions (w/o cap)	191mm/7.52 in(L) x 49mm/1.93 in(H) x 25mm/1 in(W)
Soldering Iron	162mm/6.4 in(L) x 42mm/1.7 in (H) x 42mm/1.7 in (W)
Flashlight	w/o battery - 63 g
Weight	w/ battery - 135 g
Batteries	3 - 1.5V Alkaline AA
Operating Time	Approx. 50 minutes continuous use w/ new battery.
Approximate Temp. Soldering Tip	9 W (max.) / 900°F(480°C)
Time to Reach Operating Temp.	365°F/ 185°C in 12 seconds
Approx. Nos. of Solder joints Intermittently	160 Joints/ Using New Batteries
Tip	Patented Tip-Long Life, Iron-Plated, Anti-Corrosion

#### Important Safety Instructions Read All Prior to Use

1. The tip is extremely hot during use. Avoid contact with hands, skin and other objects.
2. Do not abuse this unit or otherwise subject the unit to strong physical shock.
3. Use only in well ventilated areas.
4. Do not touch the heated tip or knurled nut.
5. Keep away from Children
6. Always be sure the unit is cool before storing.
7. Do not replace cap without switching unit off and ensuring tip has cooled.
8. Do not attempt to readjust or repair. Unit is not user serviceable.
9. When replacing batteries, replace all of the batteries with correct type. Do not mix new batteries with used batteries or batteries of a different type.
10. Be sure to insert batteries properly (+/-).
11. Be sure to remove the batteries before storing the unit.

#### • READ ENCLOSED INSTRUCTION MANUAL PRIOR TO USE.

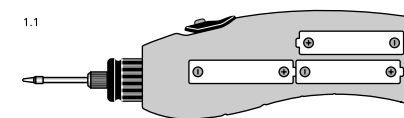
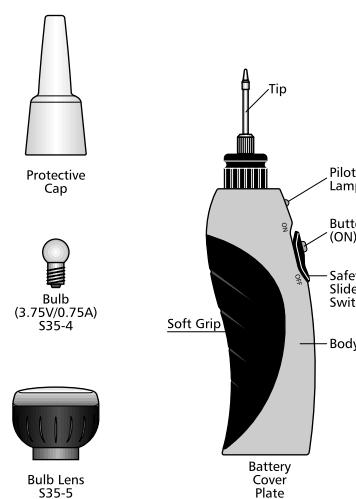

#### How to use SolderPro 35K

##### Battery Orientation

- 1.1 Remove battery cover and place alkaline battery size AA(1.5V) x 3 pcs in correct position as illustrated(fig 1.1)
- 1.2 Replace cover.

##### How to install and remove the tip

Fig. 2.1 Tip Installation and Removal

##### How to install the flashlight attachment

Fig. 3.1 Bulb installation and Removal

Fig. 3.2 Lens installation and Removal

##### How to use soldering iron

- 4.1 Move slide switch forward to ON position. For safety, "On Button" will NOT operate with slide switch in the "OFF" position
- 4.2 Push "ON" button, Pilot lamp will glow and tip will start to heat up. In about 12 seconds the tip will heat up to soldering temperatures.
- 4.3 When the pilot lamp becomes dim and it takes more than 30 seconds for solder to melt, the batteries may be exhausted. Replace with 3 new batteries.
- 4.4 Battery power is used constantly while "ON" Button is depressed and is saved when button is not pressed. Make sure finger is off the button right after soldering. Timely intermittent push on and off cycles will provide the best temperature control and prolong battery life.
- 4.5 To prolong tip life, tin the tip and make sure the slide switch is returned to OFF position when not in use.

#### Troubleshooting:

Problem	Solution
Pilot lamp goes on but tip does not heat up	Check to ensure tip is fully screwed in
Tip does not heat up and pilot lamp does not go on	Replace exhausted batteries. Reorient battery position in unit. (refer to fig. 1.1)

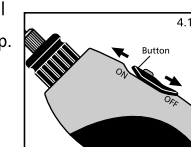
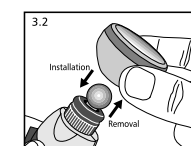
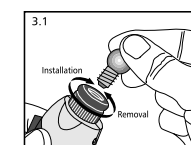
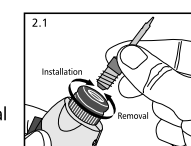
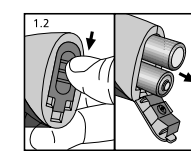

#### How to use flashlight

- 5.1 Please refer to Item 2 & 3 How to install the tip and flashlight bulb.
- 5.2 Move slide switch forward to ON position
- 5.3 Push button, flashlight will glow. Release push button to stop.
- 5.4 Return the slide switch to OFF position when not in use.

#### Soldering information

- 6.1 For fast and accurate soldering, a clean and well-tinned tip is required.
- 6.2 Heat and gently wipe with a rag or emery cloth to clean tip.
- 6.3 Re-tin to minimize oxidation.
- 6.4 Use good quality solder, rosin core or solid with proper flux for electronics work.
- 6.5 Apply solder ONLY at the point of the tip.

#### Storage

- 7.1 Always be sure the tip is cooled before replacing protective cap
- 7.2 Store when not in use. Store unit in dry, locked cabinet out of reach of children.
- 7.3 Remove batteries before storage.

#### Battery use

- 8.1 Make sure to use alkaline batteries, size AA (1.5V), 3 pcs. Other types of batteries might fail to perform as designed.
- 8.2 Heat up time becomes longer as the battery is used. Replace with new batteries when heat up time becomes increased.
- 8.3 Place batteries into unit per diagram (fig 1.1+1.2) to function properly.
- 8.4 Do not dispose of batteries or expose batteries to fire or excessive heat. Do not short circuit batteries. Do not attempt to recharge batteries. Any of the above may result in fire, serious injury or contamination.
- 8.5 Do not try to solder a battery, as it might cause fire, injury and contamination.
- 8.6 Do not touch the liquid that has leaked out of a damaged battery. If a damaged battery is touched, wash hands with water.
- 8.7 If liquid leaks out of battery in the iron body, wipe clean and replace with new batteries.
- 8.8 When not using the iron for a long period, take batteries out of the unit.
- 8.9 Do not mix new and old batteries and/or different types together at the same time in the unit.

#### Basic Tips:

